

- NOTES:**
- FOR GENERAL NOTES SEE DWG WM-S9002.
  - NUMBERING OF PILES DOES NOT INDICATE SEQUENCE OF INSTALLATION.
  - ALL PILES TO BE 400Ø HEX.
  - NOT IN CONTRACT
  - PILES WITHOUT NUMBERS ARE CALLED UP ON THE DRAWINGS FOR THE ADJACENT AREA.
  - FOR TYPICAL CAST-IN-PLACE PILE EXTENSION AND CUT-OFF DETAILS SEE WB-S0460
  - SEE PILE SCHEDULE ON DWG WO-S0505 AND WO-S0506.

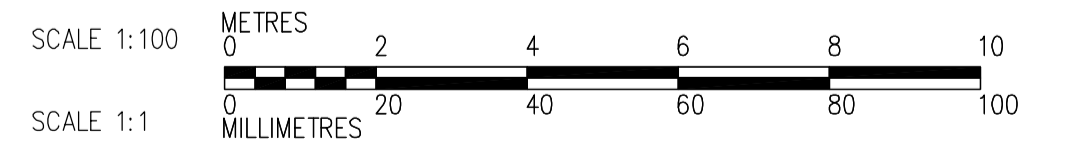
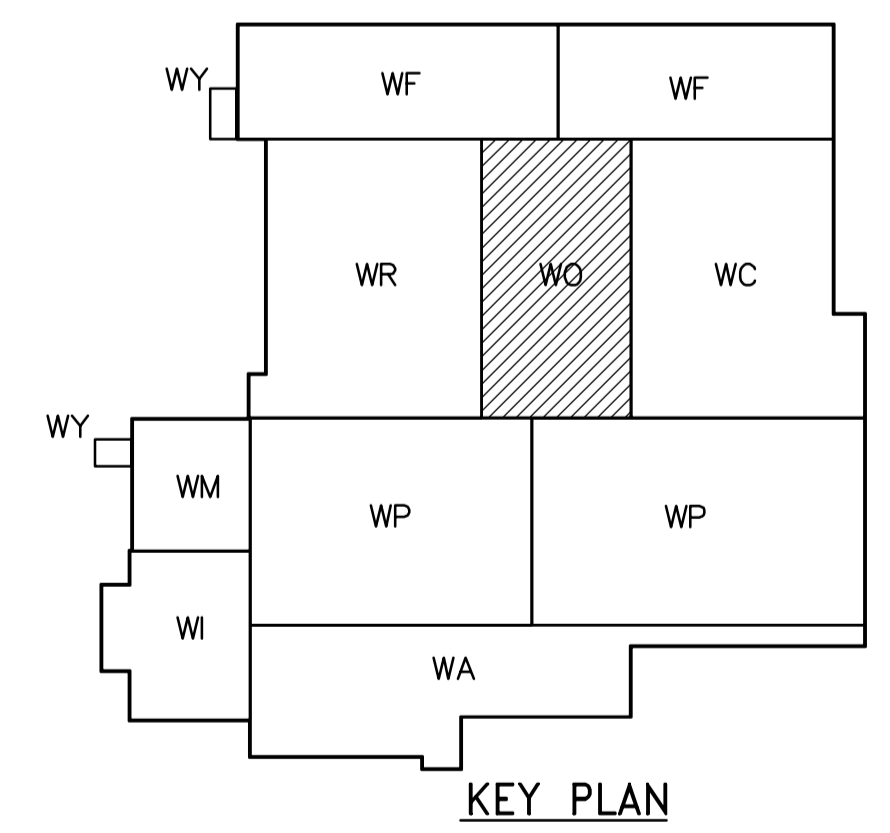

**PILING PLAN**  
1:100

<p><b>Certificate of Authorization</b> CH2M HILL Canada Ltd. No. 1441 Expiry: April 30, 2006</p>	<p>B.M. ELEV.</p>		<p>Frederickson Cooper ARCHITECTS</p>	<p>A Tetra International Ltd. Company</p>	ENGINEER'S SEAL	<p><b>THE CITY OF WINNIPEG</b> WATER AND WASTE DEPARTMENT ENGINEERING DIVISION</p>			
	DESIGNED BY	DK			CHECKED BY		AP	ORIGINAL SIGNED BY	D. KRUGER
	DRAWN BY	MS			APPROVED BY		DJT	CONSULTANT DRAWING NO.	WO-F0105
	SCALE:	1:100			RELEASED FOR CONSTRUCTION BY:		R. SOROKOWSKI	STRUCTURAL OZONATION AREA PILING PLAN	CITY FILE NUMBER
NO. REVISIONS	DATE	DATE	DATE	DATE	DATE	DATE			
01	583-2005 ADDENDUM 3	06/03/10	DK	2005/08/30	2006/02/08				
00	ISSUED FOR TENDER	06/02/03	DK						