

- NOTES:**
- FOR WALL TOC ELEVATIONS AND BOTTOM OF WALL ELEVATIONS SEE DWG. WO-S0205.
 - MONORAILS AND SUPPORT BEAMS TO BE PROVIDED AND INSTALLED IN SEPARATE CONTRACT. EMBEDDED ANCHOR RODS TO BE PROVIDED AND INSTALLED IN THIS CONTRACT.
 - AT ANY VERTICAL CONSTRUCTION JOINTS IN THE TANK PERIMETER WALLS INCLUDING THE WALL BETWEEN THE TWO TANKS ALONG B12, USE 316 STAINLESS STEEL WATERSTOP FOR OZONE TANKS AND PVC WATERSTOP FOR BACKWASH SUPPLY TANKS.

REBARS LEGEND:
 ——— TOP BARS
 - - - - - BOTTOM BARS

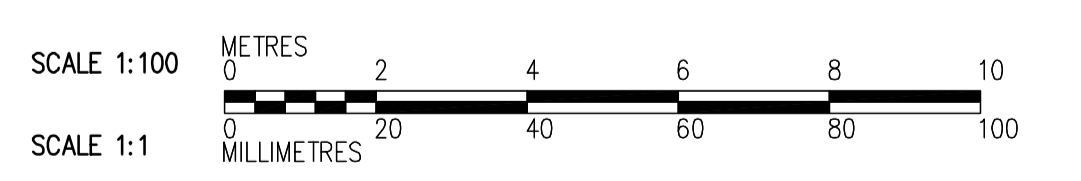
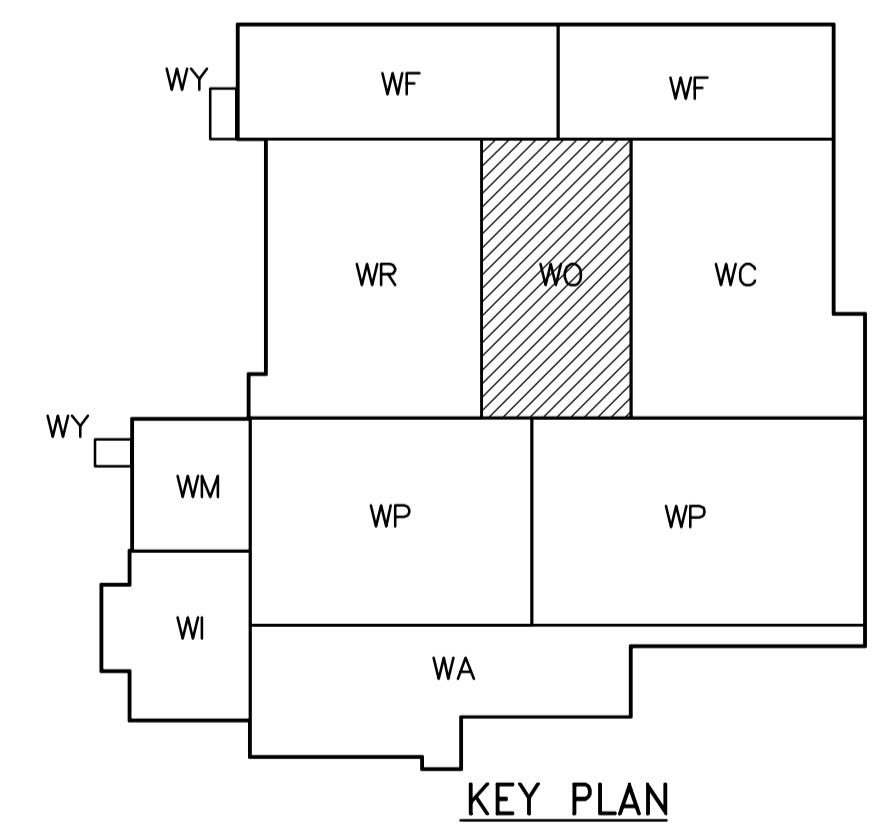
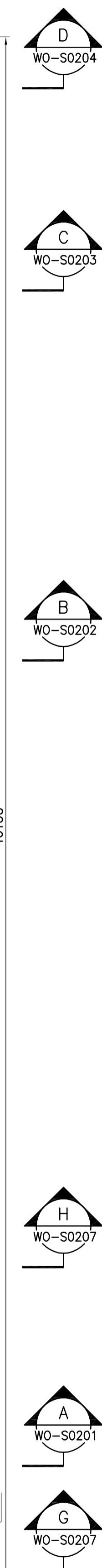

SECOND FLOOR PLAN
1:100

<p>APEGN Certificate of Authorization CH2M HILL Canada Ltd. No. 1441 Expiry: April 30, 2006</p>	<p>Frederickson Cooper ARCHITECTS</p>	<p>EarthTech A Tyco International Ltd. Company</p>	ENGINEER'S SEAL	<p>THE CITY OF WINNIPEG WATER AND WASTE DEPARTMENT ENGINEERING DIVISION</p>
			DESIGNED BY: MH CHECKED BY: AP DRAWN BY: RL APPROVED BY: DJT SCALE: 1:100 RELEASED FOR CONSTRUCTION BY: R. SOROKOWSKI DATE: 2005/07/06 DATE: 2006/02/08	