

ROOF PLAN  
1:100

NOTES:

- DESIGN SNOW LOAD = 1.56 kPa
- SUPER IMPOSED DEAD LOAD = 1 kPa
- PARAPET WALLS TO BE PROVIDED IN SEPARATE CONTRACT ALONG ALL EXTERIOR WALLS AND ALONG ALL EXPANSION JOINTS. FOR DOWEL DETAIL SEE 4
- CONNECTIONS BETWEEN TEE BEAM TO BE SPACED BY PRECAST SUPPLIER AS PER LOAD
- CAST-IN-PLACE ANGLE IN UPSTAND BEAM DESIGNED AND SUPPLIED BY PRECAST SUPPLIER, AND INSTALLED BY GENERAL CONTRACTOR
- PROVIDE 20mm  $\phi$  SLEEVES IN ALL DOUBLE TEE STEMS 1200mm C/C
- REFER TO "GENERAL NOTES" ON DWG. WM-S9002 FOR OPENINGS AND BLOCK OUTS NOT IDENTIFIED ON THIS DRAWING.

LIFTING EYE

- TYPE "1" (900 kg)
- TYPE "2" (1800 kg)

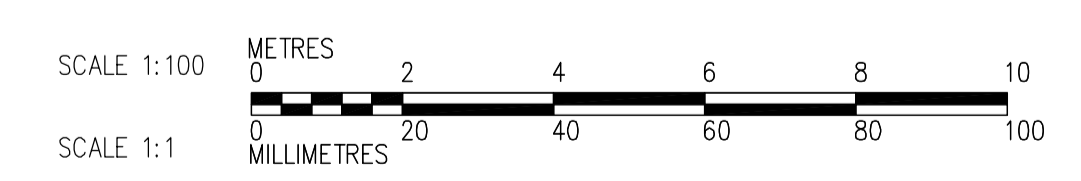
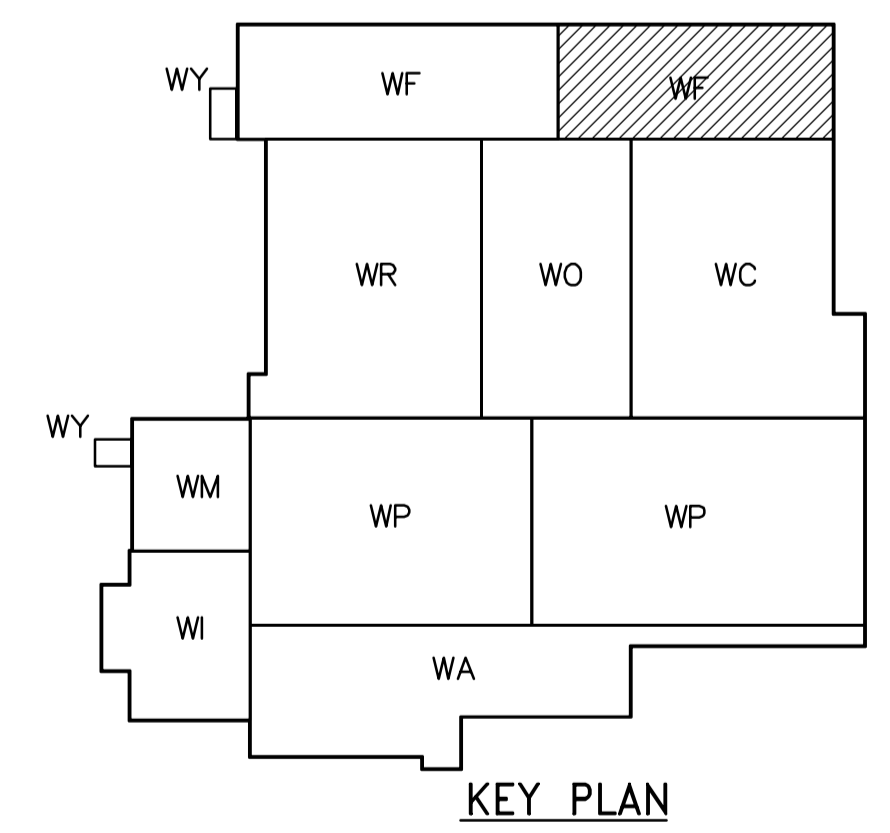

 Certificate of Authorization CH2M HILL Canada Ltd. No. 1441 Expiry: April 30, 2006	B.M. ELEV. <table border="1"> <tr><td> </td><td> </td><td> </td></tr> <tr><td> </td><td> </td><td> </td></tr> <tr><td> </td><td> </td><td> </td></tr> </table>										 Frederickson Cooper ARCHITECTS DESIGNED BY DK DRAWN BY PM SCALE: 1:100 DATE 2005/08/10	 A Terra International Ltd. Company CHECKED BY AP APPROVED BY DJT RELEASED FOR CONSTRUCTION BY: R. SOROKOWSKI DATE 2006/02/08	ENGINEER'S SEAL ORIGINAL SIGNED BY D. KRUGER 2006/02/06 CONSULTANT DRAWING NO. WF-S0147	 THE CITY OF WINNIPEG WATER AND WASTE DEPARTMENT ENGINEERING DIVISION WATER TREATMENT PLANT FILTRATION FOUNDATIONS AND CONCRETE STRUCTURES STRUCTURAL FILTRATION AREA 2 ROOF PLAN	CITY FILE NUMBER SHEET OF CITY DRAWING NUMBER 1-0601F-A-80147-001-0D
NO. REVISIONS <table border="1"> <tr><td>01</td><td>583-2005 ADDENDUM 3</td><td>06/03/10</td><td>KA</td></tr> <tr><td>00</td><td>ISSUED FOR TENDER</td><td>2006/02/03</td><td>DK</td></tr> </table>	01	583-2005 ADDENDUM 3	06/03/10	KA	00	ISSUED FOR TENDER	2006/02/03	DK							
01	583-2005 ADDENDUM 3	06/03/10	KA												
00	ISSUED FOR TENDER	2006/02/03	DK												