

F DETAIL
WT-S014 1:25

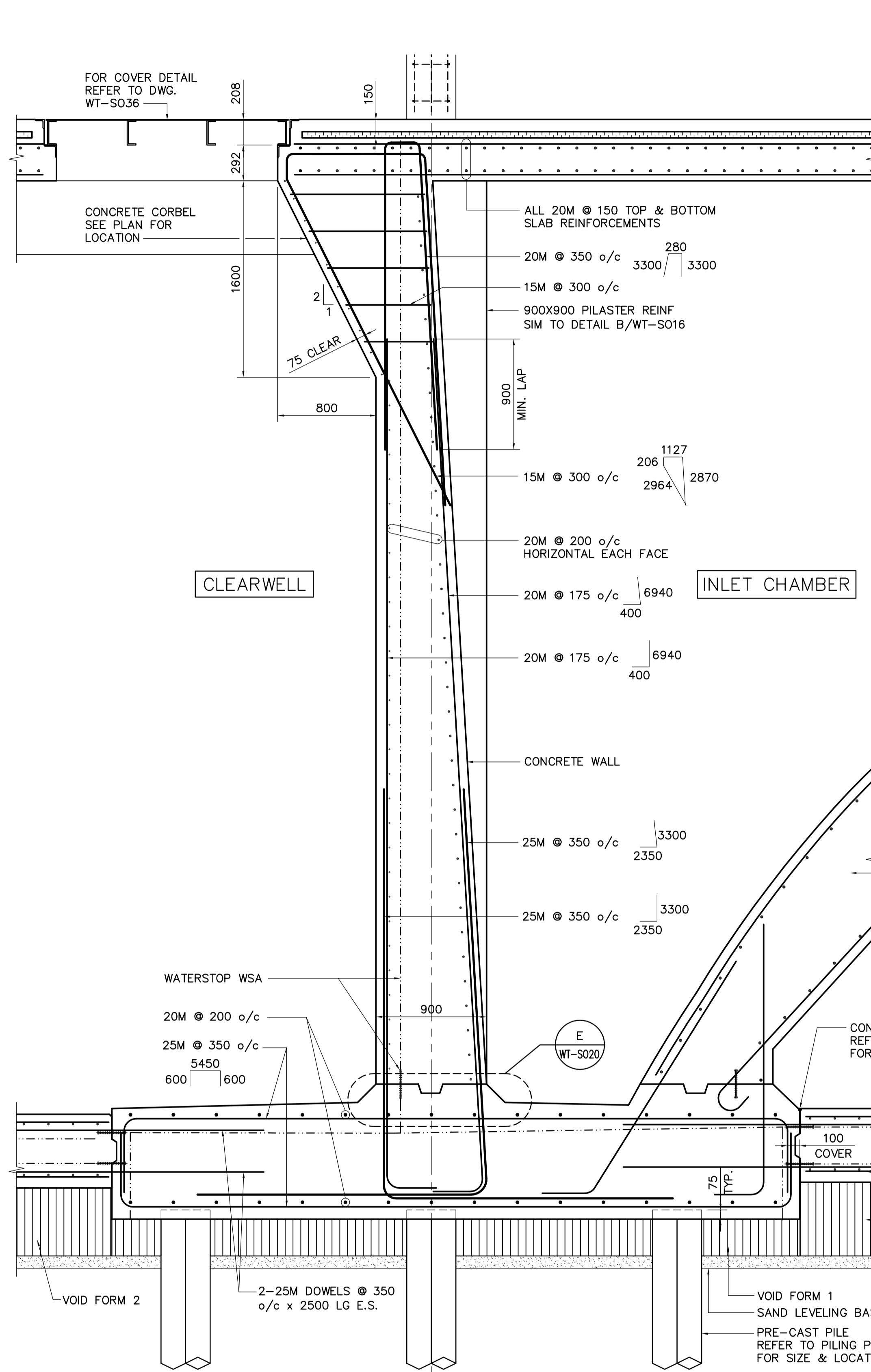

G DETAIL
WT-S014 1:25

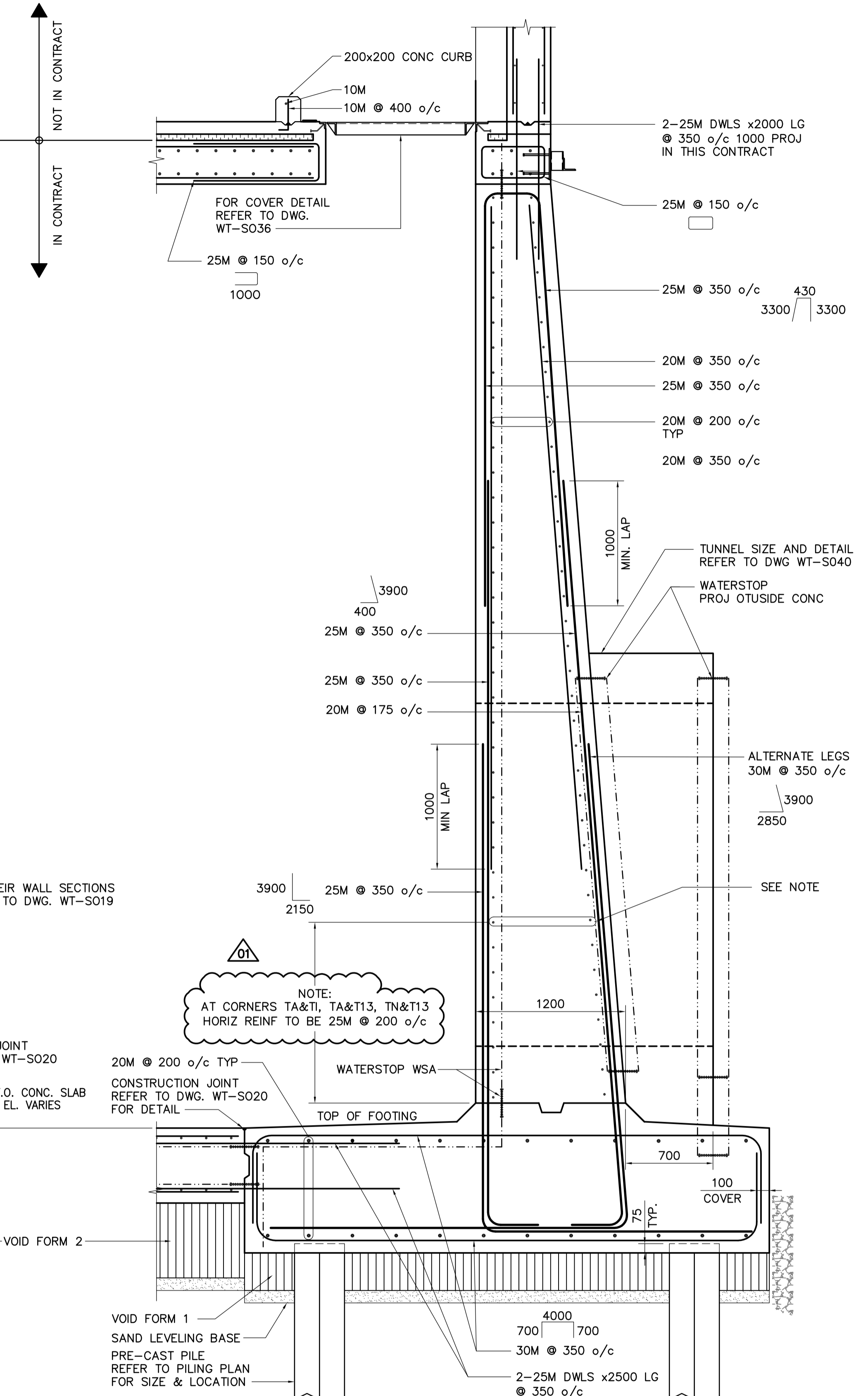

H DETAIL
WT-S014 1:25

NOTE:
AT CORNERS TA&TI, TA&T13, TN&T13
HORIZ REINF TO BE 25M @ 200 o/c

DRAWING NOTES:
1. REFER TO DRAWING WT-S001 FOR GENERAL NOTES.

APEGM
Certificate of Authorization
Earth Tech Canada Inc.
No. 730 Expiry: April 30, 2006

B.M. ELEV.			
DESIGNED BY	FK	CHECKED BY	MK
DRAWN BY	C.T. / WDB	APPROVED BY	AHL
HOR. SCALE:	AS NOTED	RELEASED FOR CONSTRUCTION BY:	R. SOROKOWSKI
VERTICAL SCALE:		DATE	2005-04-17
NO. REVISIONS	DATE	BY	
01	166-2005 ADDENDUM 1	05/05/06	C.T.
00	ISSUED FOR TENDER	05/04/17	C.T.

CH2M HILL
Frederickson Cooper
ARCHITECTS

EarthTech
A Tyco International Ltd. Company

ENGINEER'S SEAL
ORIGINAL SIGNED BY
F.A. KEMP
2005/04/17
CONSULTANT DRAWING NO.
WT-S017

THE CITY OF WINNIPEG
WATER AND WASTE DEPARTMENT
ENGINEERING DIVISION

**WATER TREATMENT PLANT
CLEARWELL CONSTRUCTION**

CITY FILE NUMBER
SHEET OF
CITY DRAWING NUMBER
1-060TT-A-80017-001-01D

STRUCTURAL SECTIONS AND DETAILS