

WATER SERVICE INFORMATION

ADDRESS	SIZE (mm) MATERIAL (STREET)	SIZE (mm) MATERIAL (PROP.)	SHORT & LONG MEASUREMENT	CORP LOCATION	REMARKS
660 KILDONAN DRIVE RESIDENTIAL	20 CU	20	3.93 SNL HSE	OPP OF S/C	RECONNECT SERVICE
661 KILDONAN DRIVE RESIDENTIAL	12 CU	12	45.658 WML HENDERSON HWY	1.4 S OF S/C	RECONNECT SERVICE
662 KILDONAN DRIVE RESIDENTIAL	20 CU	20	74.404 WML CANTERBURY PL	27.0 N OF S/C	RECONNECT SERVICE
663 KILDONAN DRIVE RESIDENTIAL	20 CU	20	57.166 WML HENDERSON HWY	0.2 N OF S/C	RECONNECT SERVICE
664 KILDONAN DRIVE RESIDENTIAL	20 CU	20	4.05 SNL HSE	OPP OF S/C	RECONNECT SERVICE
665 KILDONAN DRIVE RESIDENTIAL	20 CU	20	55.958 SSL CANTERBURY PL	OPP OF S/C	RECONNECT SERVICE
666 KILDONAN DRIVE RESIDENTIAL	25 CU	25	1.31 SSL HSE	OPP OF S/C	RECONNECT SERVICE
667 KILDONAN DRIVE RESIDENTIAL	20 CU	20	4.77 EEL HSE	OPP OF S/C	RECONNECT SERVICE
667A KILDONAN DRIVE RESIDENTIAL	20 CU	20	40.690 EEL KILDONAN DR	6.8 S OF S/C	RECONNECT SERVICE
668 KILDONAN DRIVE RESIDENTIAL	20 CU	20	7.86 SNL HSE	OPP OF S/C	RECONNECT SERVICE
667A KILDONAN DRIVE RESIDENTIAL	20 CU	20	31.661 NNL AT KILDONAN DR	OPP OF S/C	RECONNECT SERVICE
667 KILDONAN DRIVE RESIDENTIAL	20 CU	20	9.33 EEL HSE	OPP OF S/C	RECONNECT SERVICE
667A KILDONAN DRIVE RESIDENTIAL	20 CU	20	40.140 EEL KILDONAN DR	OPP OF S/C	RECONNECT SERVICE
667A KILDONAN DRIVE RESIDENTIAL	20 CU	20	9.52 WEL HSE	OPP OF S/C	RECONNECT SERVICE
668 KILDONAN DRIVE RESIDENTIAL	20 CU	20	16.242 EEL KILDONAN DR	OPP OF S/C	RECONNECT SERVICE
670 KILDONAN DRIVE RESIDENTIAL	20 CU	20	1.26 NNL HSE	OPP OF S/C	RECONNECT SERVICE
670 KILDONAN DRIVE RESIDENTIAL	20 CU	20	45.447 NNL AT KILDONAN DR	OPP OF S/C	RECONNECT SERVICE
670 KILDONAN DRIVE RESIDENTIAL	20 CU	20	10.67 SSL HSE	OPP OF S/C	RECONNECT SERVICE
672 KILDONAN DRIVE RESIDENTIAL	16 CU	16	58.796 NNL AT KILDONAN DR	OPP OF S/C	RECONNECT SERVICE
672 KILDONAN DRIVE RESIDENTIAL	16 CU	16	2.33 SSL HSE	OPP OF S/C	RECONNECT SERVICE
672 KILDONAN DRIVE RESIDENTIAL	16 CU	16	90.836 NNL AT KILDONAN DR	OPP OF S/C	RECONNECT SERVICE

* SERVICES TO BE RENEWED TO R. ALL OTHERS TO BE RECONNECTED

NOTE 1:
THIS ADDRESS IS SERVICED OFF CANTERBURY PLACE, AND IS WYED WITH 667 KILDONAN DR.

NOTE 2:
THIS ADDRESS IS SERVICED OFF CANTERBURY PLACE, AND IS WYED WITH 665 KILDONAN DR.

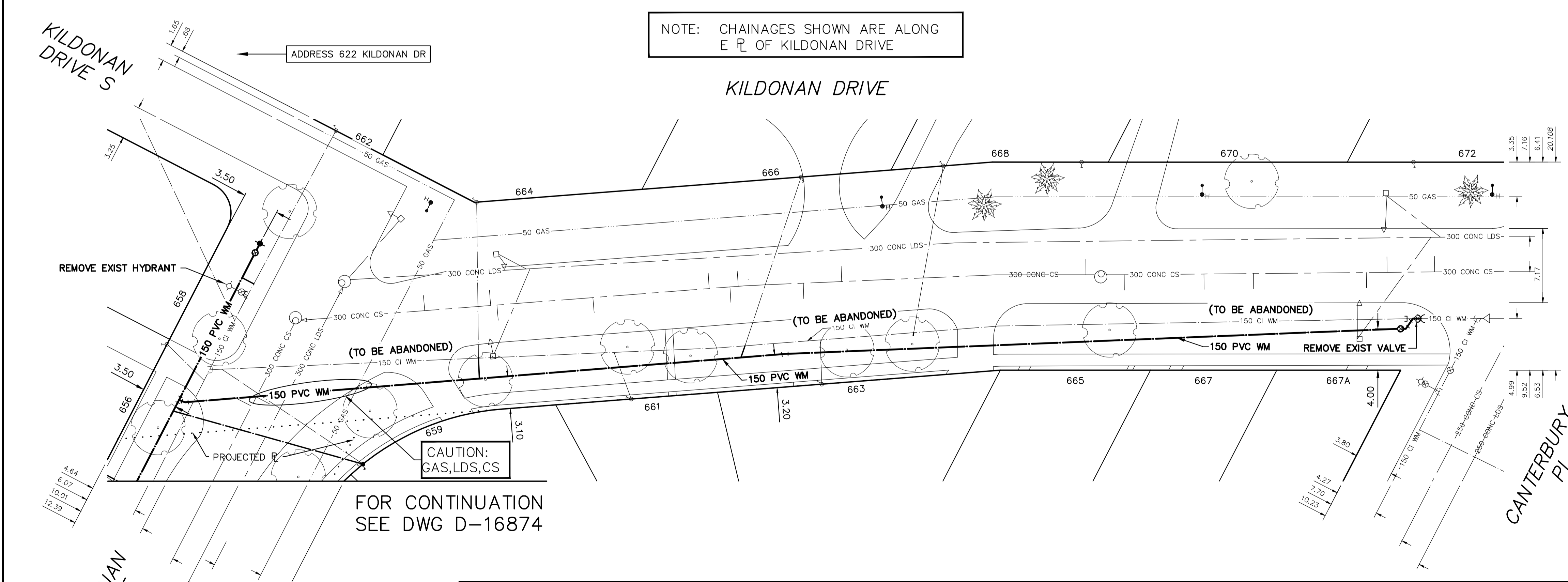

NOTE: CHAINAGES SHOWN ARE ALONG E R OF KILDONAN DRIVE

FOR INDEX SEE D-16868

NOTE: ALL VALVES TO BE INSTALLED COUNTERCLOCKWISE TO CLOSE

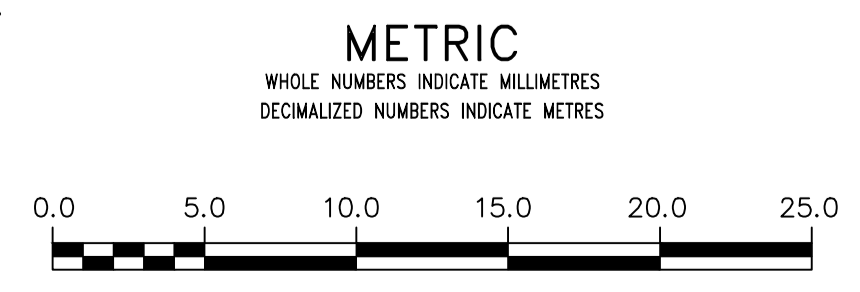

WARNING
IF POWER EQUIPMENT OR EXPLOSIVES ARE TO BE USED FOR EXCAVATION ON THIS PROJECT THE CONTRACTOR MUST:
1) NOTIFY THE GAS COMPANY OF THE PROPOSED LOCATION OF EXCAVATION.
2) TAKE PRECAUTION TO AVOID DAMAGE TO GAS COMPANY INSTALLATIONS.
SEE PROVINCIAL REGULATION 210/72 FOR DETAILS

LOCATION APPROVED
UNDERGROUND STRUCTURES
SUPV. U/G STRUCTURES COMMITTEE DATE
NOTE:
LOCATION OF UNDERGROUND STRUCTURES AS SHOWN ARE BASED ON THE BEST INFORMATION AVAILABLE BUT NO GUARANTEE IS GIVEN THAT ALL EXISTING UTILITIES ARE SHOWN OR THAT THE GIVEN LOCATIONS ARE EXACT. CONFIRMATION OF EXISTENCE AND EXACT LOCATION OF ALL SERVICES MUST BE OBTAINED FROM THE INDIVIDUAL UTILITIES BEFORE PROCEEDING WITH CONSTRUCTION.

VERTICAL DATUM: CGVD28 (HT2.0 Geoid)
HORIZONTAL DATUM: NAD83 (June 1990), Zone 14

NO.	REVISIONS	DATE	BY

DESIGNED BY	JB	CHECKED BY	SC
DRAWN BY	AOM	APPROVED BY	SC
SCALE:		RELEASED FOR CONSTRUCTION	
HORIZONTAL	1:250		
VERTICAL	1:50		
DATE	2024 04 09	DATE	
PLOT DATE:	2024 04 09		



THE CITY OF WINNIPEG
WATER AND WASTE DEPARTMENT
ENGINEERING DIVISION

2024 WATER MAIN RENEWALS
CONTRACT 5
KILDONAN DRIVE
KILDONAN DRIVE SOUTH TO
CANTERBURY PLACE

SHEET 8 OF 13
CITY DRAWING NUMBER
D-16875