

**NOTES:**

- REFER TO SPECIFICATION E13 CONSTRUCTION OF VARIOUS CURB TYPES FOR ASPHALT PAVEMENT OF THE TENDER DOCUMENT
- TRANSVERSE JOINT SAW CUT EVERY 3.0m TO A MAXIMUM DEPTH OF 25mm

**CONSTRUCTION NOTES**

- REMOVE EXISTING PAVEMENT AND CONSTRUCT NEW 125mm ASPHALT PAVEMENT
- CONSTRUCT NEW CONCRETE CURB FOR ASPHALT PAVEMENT (SD-200A, E13)
- RENEW EXISTING CONCRETE SIDEWALK (SD-228A)
- INSTALL NEW DETECTABLE WARNING SURFACE TILE (SD-229E)
- CONSTRUCT CURB RAMP (SD-200A, SD-229C, SD-229D)
- RE-GRADE EXISTING PRECAST SIDEWALK BLOCKS
- RE-GRADE EXISTING PAVERS
- LIMIT OF RECONSTRUCTION
- INSTALL NEW FRAME AND SOLID COVER (AP-006, AP-007) AND ADJUST TO GRADE
- INSTALL NEW 1200 CATCH BASIN WITH CURB AND GUTTER INLET FRAME (SD-024), AND CONNECT TO SEWER WITH 250mm Ø PVC PIPE AS PER CW 2130
- INSTALL 6.0m - 150mm Ø SUB DRAINS (BOTH SIDES), CONNECT TO CATCH BASIN (SD-245) AND CAP ENDS AS PER CW 3120
- ABANDON EXISTING CATCH BASIN & DRAINAGE INLET AS PER CW2130
- CONSTRUCT NEW 100mm CONCRETE SIDEWALK (SD-228A)
- REMOVE EXISTING APPROACH AND CONSTRUCT NEW 150mm REINFORCED CONCRETE APPROACH (SD- 232)
- REMOVE EXISTING APPROACH AND CONSTRUCT NEW 150mm REINFORCED CONCRETE APPROACH (SD- 235)
- CONSTRUCT NEW CONCRETE LIP CURB FOR ASPHALT PAVEMENT (SD-200A)
- CONSTRUCT MIN. 150mm CONCRETE ISOLATION AND INSTALL TYPE B PAVEMENT REPAIR FABRIC (SD-220D)
- LIGHT STANDARD TO BE INSTALLED IN ACCORDANCE WITH SPECIFICATION E18 OF THE TENDER DOCUMENT
- CONSTRUCT 150mm REINFORCED CONCRETE PAVEMENT

**GENERAL NOTES**

- PAVEMENT DIMENSIONS ARE TO BACK OF CURB
- ALL CURB RADII UNDER 15.0m SHALL BE MODIFIED (SD-203B)
- CURB REPLACEMENT AS DIRECTED BY CONTRACT ADMINISTRATOR
- CONTRACTOR TO CONFIRM THE LOCATION OF ALL UTILITIES/SERVICES IN THE FIELD PRIOR TO CONSTRUCTION
- ADJUST ALL EXISTING WATER VALVES AND CURB STOPS TO GRADE
- PAVEMENT REPAIRS SHOWN ARE A REPRESENTATIVE SAMPLE OF THE TENDER QUANTITIES

**ISSUED FOR TENDER**  
NOT TO BE USED FOR CONSTRUCTION

**METRIC**  
WHOLE NUMBERS INDICATE MILLIMETERS  
DECIMALIZED NUMBERS INDICATE METERS  
TENDER NO. 4-2024

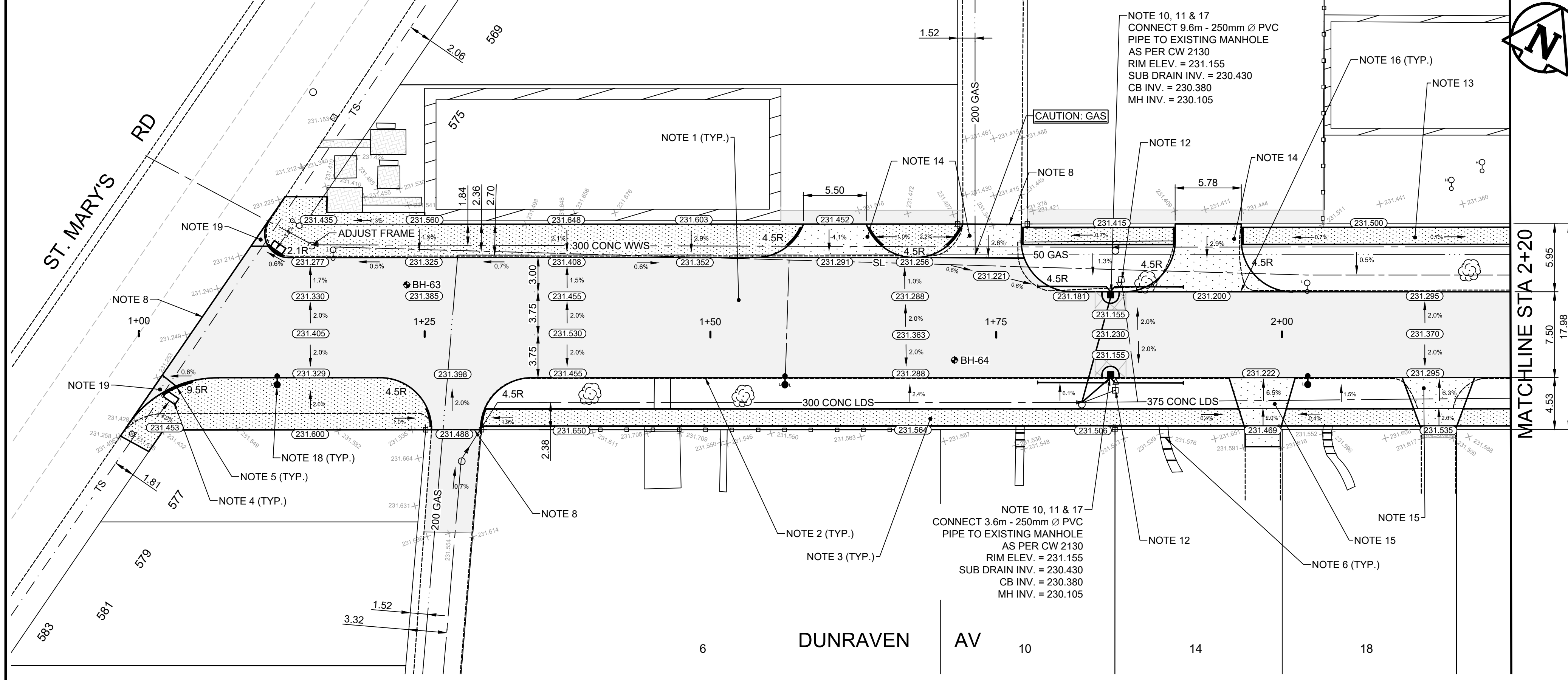

EXISTING	LEGEND - PLAN	PROPOSED	EXISTING	LEGEND - PLAN	PROPOSED	EXISTING	LEGEND - PROFILE	PROPOSED
⊕	HYDRANT	⊕	---	LDS/WWS	---	---	CONCRETE	---
⊗	VALVE	⊗	---	WATERMAIN	---	---	CONCRETE SIDEWALK	---
○	CURB STOP	○	---	GAS	---	---	ASPHALT	---
⊙	MANHOLE	⊙	---	TRAFFIC SIGNALS	---	---	PAVING STONES	---
□	CATCH BASIN	□	---	HYDRO/STREET LIGHT	---	---	GRAVEL	---
△	CURB INLET	△	---	MTS/SHAW	---	---	WOOD FENCE	---
○	HYDRO POLE	○	---	CURB RENEWAL	---	---	PAVEMENT REPAIR FABRIC	---
○	LIGHT STANDARD	○	---	PROPERTY LINE	---	---	ELEVATIONS	---
○	SIGNALS PIT	○	---	RAMP CURB	---	---	NORTH GUTTER	---
⊕	SURVEY BAR	⊕	---	TEST HOLE	---	---	CENTER LINE	---
⊕	GUY WIRE ANCHOR	⊕	---	TREE	---	---	SOUTH GUTTER	---

LOCATION APPROVED	DATE
UNDERGROUND STRUCTURES	

**NOTE:**  
LOCATION OF UNDERGROUND STRUCTURES AS SHOWN ARE BASED ON THE BEST INFORMATION AVAILABLE. BUT NO GUARANTEE IS GIVEN THAT ALL EXISTING UTILITIES ARE SHOWN OR THAT THE GIVEN LOCATIONS ARE EXACT. CONFIRMATION OF EXISTENCE AND EXACT LOCATION OF ALL SERVICES MUST BE OBTAINED FROM THE INDIVIDUAL UTILITIES BEFORE PROCEEDING WITH CONSTRUCTION.

B.M. ELEV.	IB @ SE PL - 29 BLENHEIM AVE
	231.116

DESIGNED BY	CHECKED BY
V.S.	G.K., R.W.

DRAWN BY	APPROVED BY
V.S.	M.L.

NO.	REVISIONS	DATE	BY
3.	ISSUED FOR TENDER	2403/18	R.C.
2.	SUBMIT FOR ENGINEERS REVIEW	2402/06	T.K.
1.	SUBMIT FOR PLAN APPROVAL	2402/02	T.K.

**ENGINEERING DIVISION**  
TECHNOLOGY SERVICES BRANCH  
106 - 1155 PACIFIC AVE

**THE CITY OF WINNIPEG**  
PUBLIC WORKS DEPARTMENT

**DUNRAVEN AVENUE**  
FROM ST. MARY'S ROAD TO OVERTON STREET  
ASPHALT RECONSTRUCTION AND ASSOCIATED WORKS  
FROM STA. 1+05 TO STA. 2+20

CITY DRAWING NUMBER SE-24-08  
SHEET 8 OF 17  
1