

CONSTRUCTION NOTES:

- ISOLATE MISCELLANEOUS ITEMS IN NEW CONCRETE WORKS AS PER SD-228C.
- ALL WORK AND MATERIALS TO BE IN ACCORDANCE WITH LATEST REVISION OF THE CITY OF WINNIPEG STANDARD CONSTRUCTION SPECIFICATIONS.
- LEGAL PLAN AND UNDERGROUND INFORMATION FROM CITY OF WINNIPEG LBIS. CONTRACTOR TO VERIFY ALL UNDERGROUNDS IN THE FIELD.
- CONTRACTOR TO TAKE PRECAUTIONARY STEPS TO AVOID DAMAGE FROM CONSTRUCTION ACTIVITIES TO TREES WITHIN THE LIMITS OF CONSTRUCTION.
- LOCATION OF EXISTING SERVICES TO BE CONFIRMED IN THE FIELD BY THE CONTRACTOR.
- INSTALL CB LEADS AT MIN. 1.0% SLOPE OR AS DIRECTED BY THE CONTRACT ADMINISTRATOR.
- CONTRACTOR TO CONFIRM EXISTING LEAD INVERT ELEVATIONS PRIOR TO INSTALLATION.
- ALL DIMENSIONS ARE TO BACK OF CURB.
- LIMITS OF CURB AND SIDEWALK RECONSTRUCTION TO BE FINALIZED IN THE FIELD BY THE CONTRACT ADMINISTRATOR.
- ADJUST ALL WATER VALVES, MANHOLES, CATCH BASINS, CATCH PITS AND WATER SHUT OFF VALVES TO GRADE.
- ALL PRIVATE WALKWAYS TO BE ADJUSTED TO NEW SIDEWALK OR TOP OF CURB ELEVATION, AS REQUIRED.
- STREET LIGHT STANDARDS, HYDRO POLES AND ANCHORS THAT REQUIRE TEMPORARY SUPPORT, REMOVAL OR REPLACEMENT, ARE TO BE DONE AT THE EXPENSE OF THE CONTRACTOR, AS NECESSARY.
- FOR ROAD RECONSTRUCTIONS, INSTALL 6 m OF 150 mm SUBDRAIN TO CATCH BASINS IN BOTH DIRECTIONS PARALLEL TO ROADWAY AS PER SD-245 AND CAP ENDS.
- FOR ROAD RECONSTRUCTIONS, ALL WATER MAIN SERVICES NEED TO BE INSULATED. ADDITIONALLY, ALL CATCH BASINS, MANHOLES AND LEAD PIPES LOCATED WITHIN 2.0 m OF A RESIDENTIAL SERVICE MUST BE INSULATED TO PROTECT THE SERVICE FROM POTENTIAL FUTURE FREEZING.
- FOR ROAD RECONSTRUCTIONS, CURB REVEAL SHALL BE 180 mm UNLESS NOTED OTHERWISE. FOR ROAD REHABILITATIONS, CURB REVEAL SHALL BE 150 mm UNLESS NOTED OTHERWISE.
- CONSTRUCT MODIFIED BARRIER CURB (SD-203B) AT RADII.

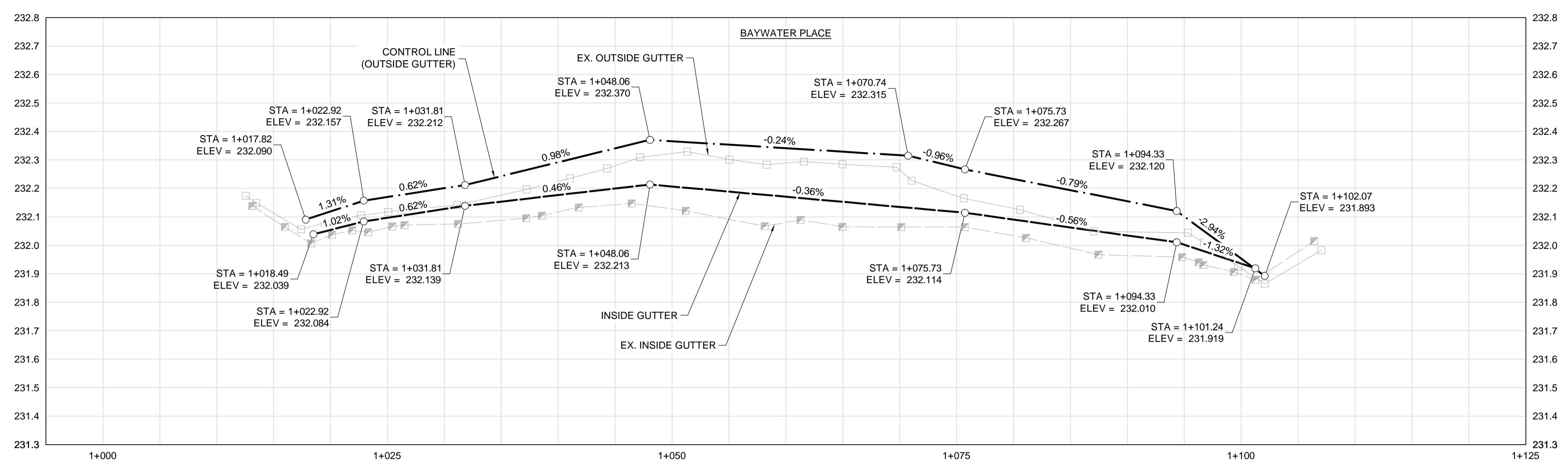

REMOVALS / RELOCATES (Red pentagon symbol)

REMOVALS / RELOCATES (BY OTHERS) (Blue pentagon symbol)

ADJUSTMENTS (Green circle symbol)

ADJUSTMENTS (BY OTHERS) (Orange circle symbol)

ABBREVIATIONS:

CONC	CONCRETE	HYDRO	HYDRO MANHOLE
ASP	ASPHALT	TMH	TELEPHONE MANHOLE
TYP	TYPICAL	WVS	WATER VALVE
EX	EXISTING	HYD	HYDRANT
MH	MANHOLE	WV	WATER VALVE
WV	WATER VALVE	EL	ELEVATION
EL	ELEVATION	CB	CATCH BASIN
CB	CATCH BASIN	CP	CATCH PIT
CP	CATCH PIT	CI	CURB INLET
CI	CURB INLET	CL	CONTROL LINE
CL	CONTROL LINE	SL	STREET LIGHT
SL	STREET LIGHT	TS	TRAFFIC SIGNAL
TS	TRAFFIC SIGNAL		

SYMBOLS:

(Circle with cross)	HYDRO MANHOLE
(Circle with dot)	TELEPHONE MANHOLE
(Circle with cross and dot)	TRAFFIC SIGNAL SPLICE PIT
(Circle with cross and dot)	WATER VALVE
(Circle with cross and dot)	HYDRANT
(Circle with cross and dot)	CURB STOP
(Circle with cross and dot)	GAS VALVE
(Circle with cross and dot)	HYDRO POLE
(Circle with cross and dot)	HYDRO POLE WITH LIGHT
(Circle with cross and dot)	STREET LIGHT
(Circle with cross and dot)	TRAFFIC SIGNAL
(Circle with cross and dot)	SIGNAL CONTROL BOX
(Circle with cross and dot)	BELLMTS PEDESTAL
(Circle with cross and dot)	TREE
(Circle with cross and dot)	IRON PROPERTY BAR
(Circle with cross and dot)	HYDRO GUY ANCHOR

METRIC

WHOLE NUMBERS INDICATE MILLIMETRES
DECIMALIZED NUMBERS INDICATE METRES

WARNING

IF POWER EQUIPMENT OR EXPLOSIVES ARE TO BE USED FOR EXCAVATION ON THIS PROJECT THE CONTRACTOR MUST:

- NOTIFY THE GAS COMPANY OF THE PROPOSED LOCATION OF EXCAVATION.
- TAKE PRECAUTION TO AVOID DAMAGE TO GAS COMPANY INSTALLATIONS SEE PROVINCIAL REGULATION 210/72 FOR DETAILS.
- OBTAIN EXCAVATION PERMITS PRIOR TO CONSTRUCTION.

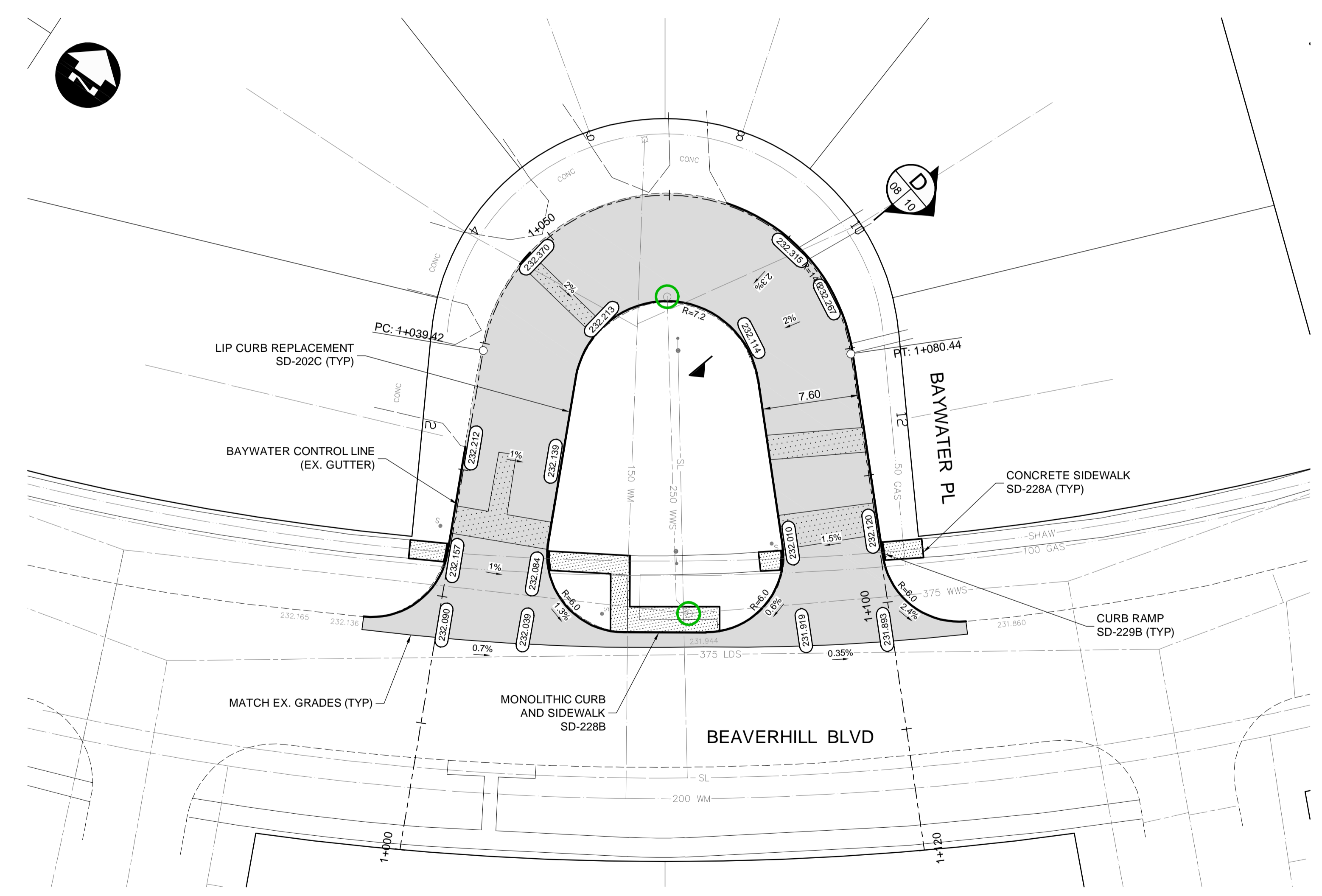

ENGINEERS GEOSCIENTISTS MANITOBA

Certificate of Authorization
Dillon Consulting Limited (MB)
No. 1789 Date: 2024/05/10

C:\pwworking\directory\projects\2023\dillon_400jh\mms62726\237222-CT-CON-BAYWATER.dwg

150 WM	WATERMAIN	150 WWS	CONCRETE ROAD	PROFILE	UNDERGROUND STRUCTURES	B.M. ELEV.	DESIGNED BY	TJH/MRD		ENGINEER'S SEAL	<p>THE CITY OF WINNIPEG PUBLIC WORKS DEPARTMENT</p> <p>2024 LOCAL STREETS RENEWAL PROGRAM DUMOULIN AVENUE AND VARIOUS OTHER LOCATIONS</p> <p>CITY DRAWING NUMBER</p>	
300 LDS	LAND DRAINAGE SEWER	300 LDS	ASPHALT ROAD	NORTH/WEST GUTTER	SUPV. U/G STRUCTURES		DRAWN BY	TJH				<p>SHEET 08 OF 10</p> <p>CONSULTANT DRAWING NUMBER</p>
250 WWS	WASTE WATER SEWER	250 WWS	CONC ROAD W/ASP OVERLAY	SOUTH/EAST GUTTER		CHECKED BY	MRD	<p>RELEASED FOR CONSTRUCTION</p> <p>DATE</p>				
HYDRO	HYDRO	HYDRO	CONCRETE SIDEWALK	NORTH/WEST MED. GUTTER		APPROVED BY	TJP					
BELLMTS	BELLMTS	BELLMTS	ASPHALT PATH	SOUTH/EAST MED. GUTTER		HOR. SCALE	1:250		<p>DATE</p>			
100 GAS	GAS	100 GAS	LANDSCAPING FEATURE	NORTH/WEST DITCH		VERTICAL	1:10					
T.S.	TRAFFIC SIGNALS	T.S.	GRASS/SOD	SOUTH/EAST DITCH								
S.L.	STREET LIGHTS	S.L.	ELEVATION	NORTH/WEST SIDEWALK								
	MANHOLE		PROPERTY LINE	SOUTH/EAST SIDEWALK								
	CATCH BASIN		CURB RAMP									
	CATCH PIT		DETECTABLE TILE									
EXISTING	LEGEND-PLAN	PROPOSED	EXISTING	LEGEND-PROFILE	PROPOSED							